

## Piezoelectric accelerometer Model 2225

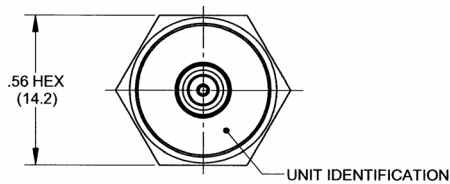

TYPICAL AMPLITUDE RESPONSE, MODEL 2225

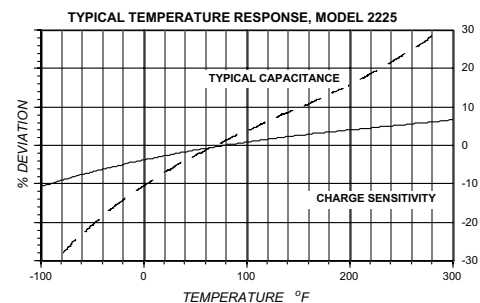
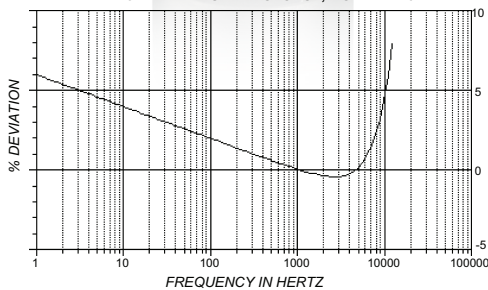

MATES WITH ENDEVCO  
3000 SERIES CABLES WITH  
10-32 UNF-2B CONNECTOR

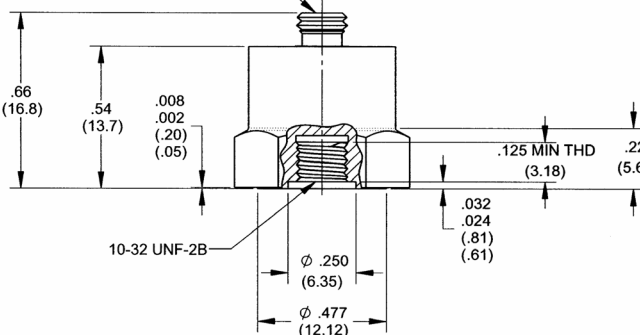

STANDARD TOLERANCE  
INCHES (MILLIMETERS)  
XX = ± .02 (X = ± .5)  
.XXX = ± .010 (.XX = ± .25)

SOL

### Key features

- High-g shock
- Industry standard
- Rugged - requires no external power
- Annular shear
- Shock measurements on test articles and structures

The Endevco® model 2225 is a lightweight piezoelectric accelerometers designed specifically for measuring high-g shock on structures and test articles. This sensor is the industry standard for shock accelerometers. The model 2225 features a 10-32 threaded hole. The accelerometer is a self-generating device that requires no external power source for operation.

Model 2225 features Endevco's Piezite® type P-10, operating in annular shear mode. These specially designed crystals exhibit low base strain sensitivity, high resonance frequency, and excellent output stability over time. Signal ground is connected to the outer case of the unit. The accelerometer features a 10-32 top connector and requires a low-noise coaxial cable for error-free operation.

Endevco signal conditioner models 133, 2771C, 2775B, 6634C or Oasis 2000 (4990A-X with cards 428 and/or 433) are recommended for use with these high impedance accelerometers.

## Piezoelectric accelerometer

### Model 2225

#### Specifications

The following performance specifications conform to ISA-RP-37.2 (1964) and are typical values, referenced at +75°F (+24°C) and 100 Hz, unless otherwise noted. Calibration data, traceable to National Institute of Standards and Technology (NIST), is supplied.

Dynamic characteristics	Units	2225
<b>Charge sensitivity</b>		
Typical	pC/g	0.75
Minimum	pC/g	0.60
<b>Frequency response</b>		See typical amplitude response
<b>Resonance frequency [1]</b>	kHz	100
<b>Amplitude response</b>		
±10%	Hz	1 to 10 000
±1 dB (ref)	Hz	1 to 10 000
<b>Temperature response</b>		
-67°F (-55°C) max/min	%	-15/0
+350°F (+177°C) max/min	%	+25/0
<b>Transverse sensitivity</b>	%	≤ 5
<b>Amplitude linearity [2]</b>	%	0.5 per 1000 g, 0 to 20 000 g
<b>Electrical characteristics</b>		
<b>Output polarity</b>		Acceleration directed into base produces positive output
<b>Resistance</b>	Ω	≥ 10
at 350°F (+177°C)	Ω	≥ 1
<b>Grounding</b>		Signal return connected to case
<b>Capacitance</b>	pF	800
<b>Environmental characteristics</b>		
<b>Temperature range</b>		-67°F to +350°F [-55°C to +177°C]
<b>Humidity</b>		Epoxy sealed, non-hermetic
<b>Sinusoidal vibration limit</b>	g pk	10 000
<b>Shock range [3]</b>	g pk	20 000
<b>Base strain sensitivity</b>	equiv. g pk/μ strain	0.03
<b>Thermal transient sensitivity</b>	equiv. g pk/°F [1/°C]	0.005 [0.009]
<b>Physical characteristics</b>		
<b>Dimensions</b>		See outline drawing
<b>Weight</b>	gm (oz)	13 (0.46)
<b>Case material</b>		Stainless steel
<b>Connector</b>		Coaxial, 10-32 thread, mates with Endevco 3000 series cables
<b>Mounting torque</b>	lbf-in (Nm)	18 (2)
<b>Calibration</b>		
<b>Supplied:</b>		
<b>Frequency response</b>	%	20 Hz to 10 000 Hz
	dB	10 000 to 50 000 Hz
<b>Charge sensitivity</b>	pC/g	
<b>Maximum transverse sensitivity</b>	%	
<b>Capacitance</b>	pF	

## Piezoelectric accelerometer Model 2225

### Accessories

Product	Description	2225
3090C-120	Cable assembly, 10 ft	Included
2981-12	Mounting stud, 10-32, Hex I.D.	Included
EHM464	Wrench, hex key	Included
2981-3	Stud, 10-32 adapter	Optional
2982-1	Mounting stud 10-32 to 6-32 adapter	Optional
EJ3	Connector	Optional
133	Signal conditioner	Optional
2771C	In-line charge convertor	Optional
2775B	Signal conditioner	Optional
6634C	Signal conditioner	Optional
4990A-X	Oasis 2000 computer-controlled system with cards 428 and/or 433	Optional

### Notes:

1. Minor resonances between 30 kHz and 80 kHz exist.
2. Low-end response of the transducer is a function of its associated electronics.
3. Short duration shock pulses, such as those generated by metal-to-metal impacts, may excite transducer resonance and cause linearity errors. See TP290 for more details.
4. Maintain high levels of precision and accuracy using Endevco's factory calibration services. Call Endevco's inside sales force at 866-ENDEVCO for recommended intervals, pricing and turn-around time for these services as well as for quotations on our standard products.

### Contact

#### ENDEVCO

[www.endevco.com](http://www.endevco.com)

Tel: +1 (866) ENDEVCO

[+1 (866) 363-3826]